

**Note:**  
 No dimensions on this drawing are to be scaled.  
 All levels and dimensions on this drawing are to be checked on site. Any discrepancies on this drawing are to be reported to and verified with the architect.  
 This drawing is to be read in conjunction with all other application documentation and information as issued.  
 This is not a construction drawing, it is unsuitable for the purpose of construction and must on no account be used as such.  
 This drawing is the copyright of Bucholz McEvoy Architects Ltd and may not be copied, altered, or reproduced in any form or passed to a third party without license or written consent.  
 All extracts from ordnance survey tile ref: 3263-11, 3263-16  
 Copyright: Ordnance Survey Ireland

- Occupancy:**
- STUDIO
  - 1 BED
  - 2 BED
  - 3 BED

- Note: "TOP" refers to top of parapet level.**
- R1 Roof type 1 - Flat Roof
  - R2 Roof type 2 - Extensive green roof system
  - R3 Roof type 3 - Intensive green / blue roof system with terrace
  - R4 Roof type 4 - Intensive green roof system
  - R5 Roof type 5 - Intensive green roof system with PV Panels over
  - R6 Roof type 6 - Roof Deck / Terrace
  - R7 Roof type 7 - Roof Terrace
- Please refer to Roof Plans MR1 /MR2 - A2 - 07 for parapet levels and complete key to all elevation/section drawings.

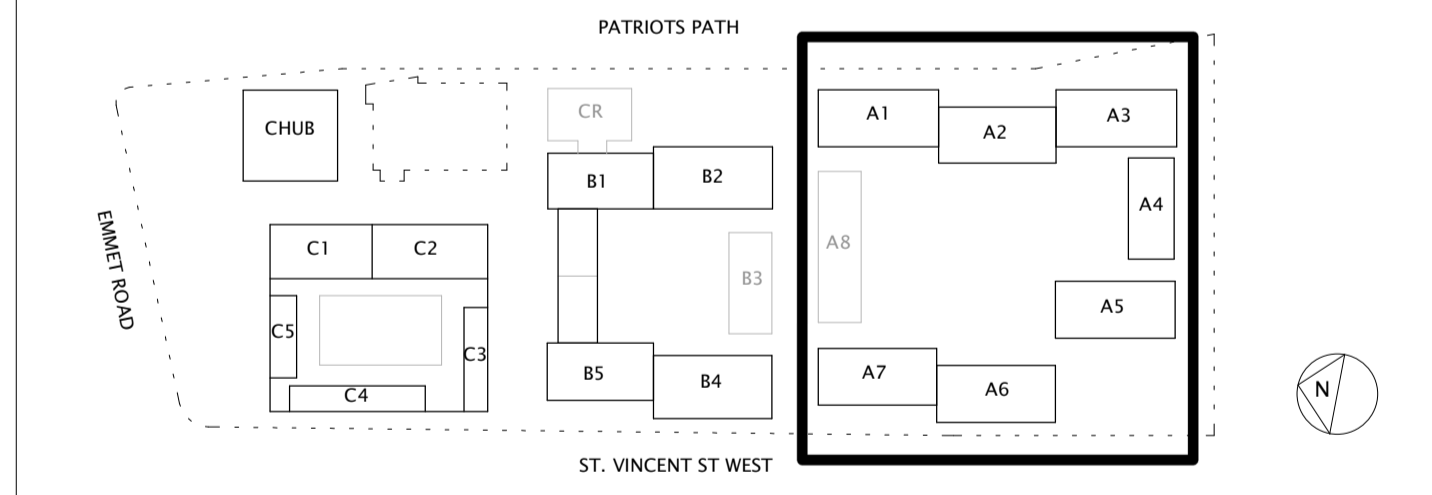

**PLANNING**

revision	date	no.

**drawing**  
**BLOCK A - MR1 - ROOF PLAN**

drawing no.	scale 1 : 200 @ A1	drawn JMP, MH, JM	project no. 0318
0318-MR1-A2-07	date SEPT 2022	checked KH, DH	revision

project  
**EMMET ROAD MIXED-USE DEVELOPMENT, DUBLIN 8**

client  
**DUBLIN CITY COUNCIL**